

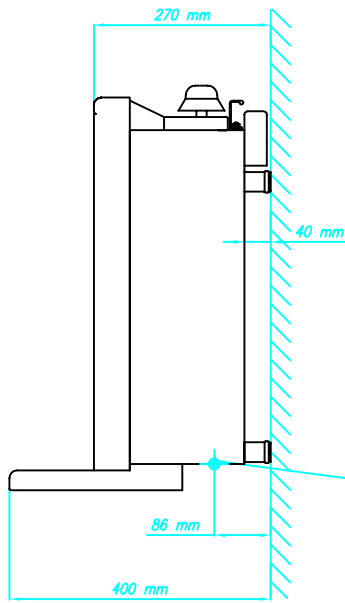

# MACFRIN Group

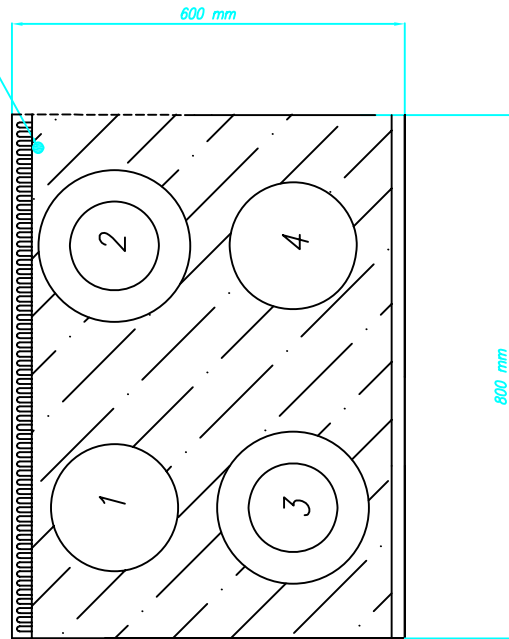

Acometida electrica

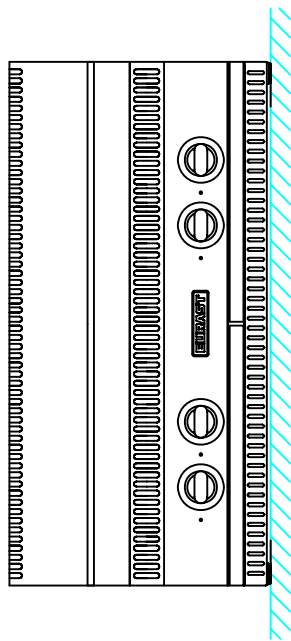

| Num.  | W                |
|-------|------------------|
| 1     | 1.800            |
| 2     | de 1.000 a 2.500 |
| 3     | de 1.000 a 2.500 |
| 4     | 1.800            |
| TOTAL | 8.600            |

COOKING SYSTEMS,SL

DESCRIPCION: HORNILLO CON 4 PLACAS VITRO

FECHA:

DIMENSIONES: 800X600X270

08-2007

MODELOS: 3033 - S4VE - S40V

POTENCIA GAS:

-

POTENCIA ELECTRICA:

8'6 KW -  $\frac{230}{1}$  V

CODIGO:

3033ACO